

Name of School: Muhlenberg South Elementary School

Location: Muhlenberg County

Grades Served: PS-5

Completion Date: 2007

Architectural Firm: Clotfelter-Samokar



School Information

School Name: Muhlenberg South Elementary School

School District: Muhlenberg County

School District Web Site Link: www.muhlenberg.kyschools.us

KDE Rated Student Capacity: 750

Grades Served: PS-5

Gross building area by floor: 82,863 square feet

Gross building area total: 82,863 square feet

Gross area per student: 110 square feet

Site area (acres): 38

Site amenities included in project: Playground, Athletic Fields, Covered Exterior Dining Patio

Special Considerations/Descriptive Info: Two courtyards, one with a stained concrete map of the United States and the other with a stained concrete solar system. The second courtyard also has a built in amphitheater.

High Performance Features: Geothermal HVAC, Energy Recovery Units, Day Lighting, Occupancy Sensors, High Efficiency Lighting, Low-E Insulating Glazing



Construction Information

Final Construction Contract Cost (total amount): \$11,116,788

Final Construction Contract Cost (per square foot): \$134.00

Original BG-1 Date: August 2003

Bid Date: 03/31/04

Completion Date: 2007

Construction Type: Pre-Engineered Metal with Masonry

Roof Design/Materials: Metal

Number of Floors: 1

Heating Fuel Type: Electricity

Heating & A/C System Type: Geothermal Hydronic Heat Pumps

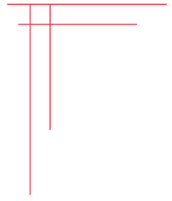

Team Information

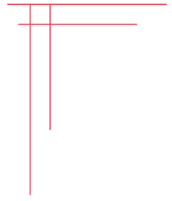

Architecture Firm

Name: Clotfelter-Samokar

Contact: David Samokar

Address: 228. E. Reynolds Rd.

Phone: 859-273-3700

FAX: 859-271-6605

Email: dsamokar@clotfelter-samokar.com

Web Site Address/Link: www.clotfelter-samokar.com

Project Team Info

Structural Engineer: Joe M. Poage

Mechanical/Electrical Engineer: Clotfelter-Samokar

Civil Engineer: N/A

General Contractor: Alliance Corporation

Construction Manager: N/A

Landscape Architect: Clotfelter-Samokar



Site Plan

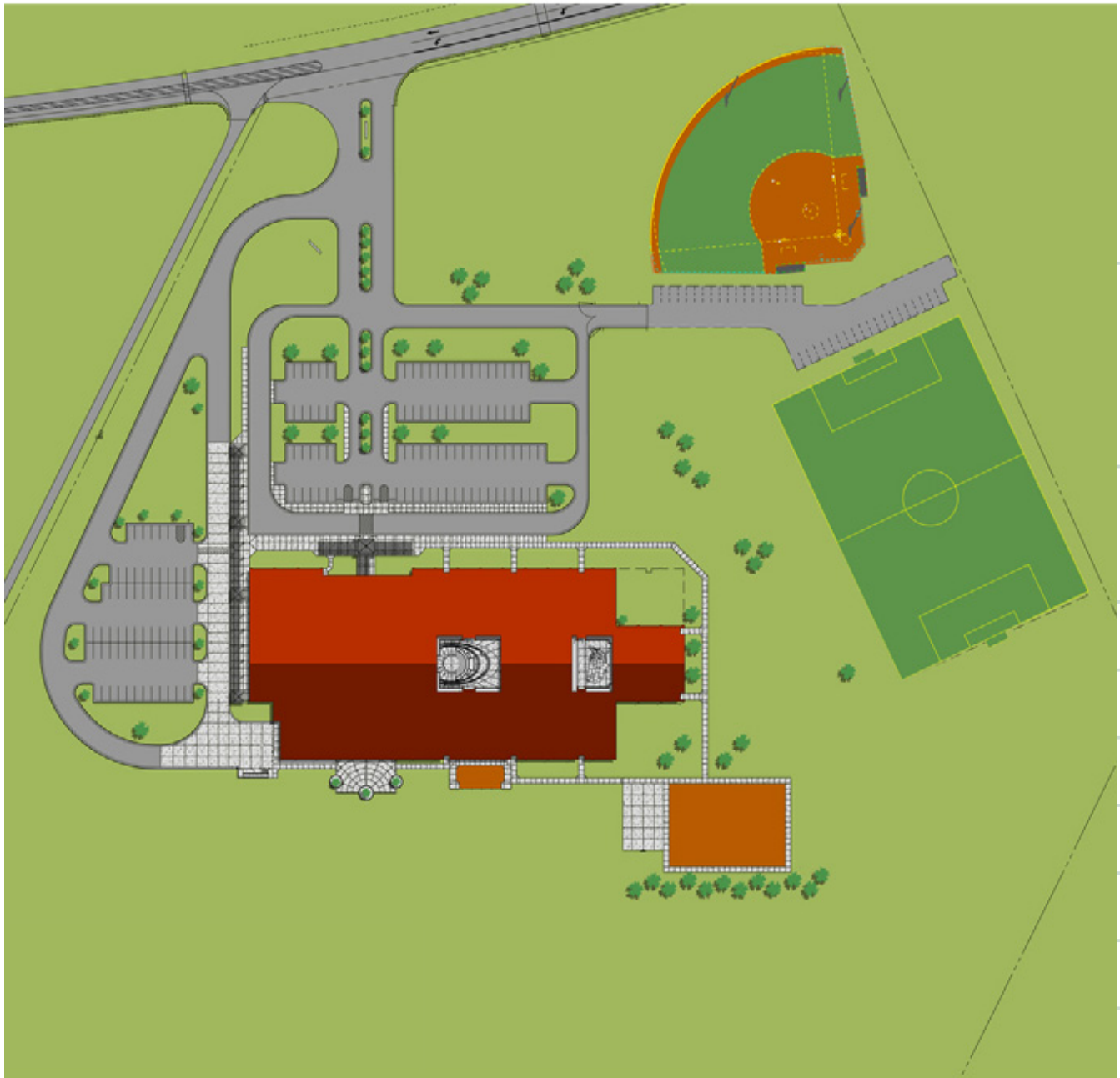

The plans, designs and photographs published herein are the property of the named architect of record. Any use, other than incidental printing for further study, is prohibited without the express written consent of the architect of record.

First Floor Plan

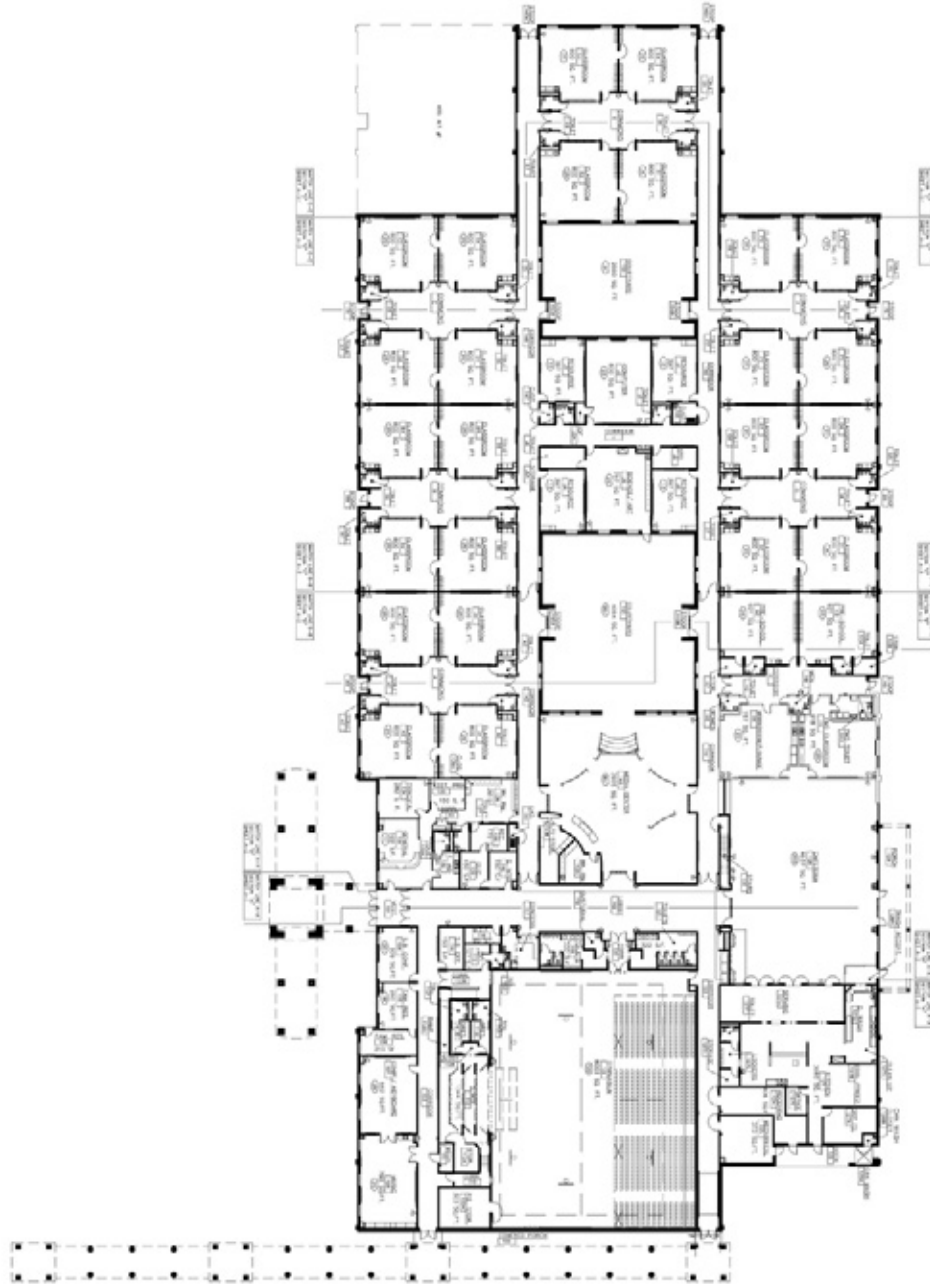

 Clotfelter **SAMOKAR**
Muhlenberg South Elementary
School
First Floor Plan



The plans, designs and photographs published herein are the property of the named architect of record. Any use, other than incidental printing for further study, is prohibited without the express written consent of the architect of record.

